

Swivel castor 540 11x22 50 PEL

Furniture Castors Series 540 ST - Wheel PEL

-20 °C - +60 °C

+++
swivels easily

+++
wear resistant

+++
shock proof

+++
floor protective

+++
weather proof

Wheel

Casted high quality nylon wheel, blackelectrically conductive
<10⁴Ω

Zinc-die-cast housing - chrome plated
Swivel bearing with combined
plain-ball bearing
Wheel brake - glass fibre reinforced
Wheel axle revited

| | |
|---|--------------------------------|
| Swivel castor | Wheel-Ø A x width B mm: 52x8+8 |
| Load Capacity kg: | 40 |
| Load capacity tested according to EN 12530 and EN 12527 | |
| Overall height H mm: | 62 |
| Stern mm: | 11x22 |
| Swivel radius SR mm: | 52 |
| Wheel bearing: | Nylon plain bearing |

Advantages

- ✓ electrically conductive
- ✓ easy running on smooth floors
- ✓ impact proof
- ✓ high abrasion resistance
- ✓ easy to clean
- ✓ high chemical resistance

©Copyright 2024 Rollenbau GmbH, www.rollenbau.at 20.05.2024

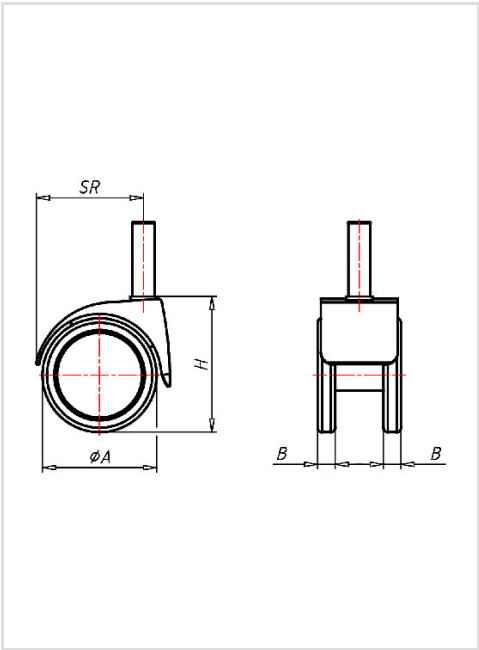

Applications

- Health-Professionals